

User manual  
Washing machine

HW80-DM14876TNZP  
HW100-DM14876TNZP

# Thank You

Thank you for purchasing this product.

Please read these instructions carefully before using this appliance. The instructions contain important information which will help you get the best out of the appliance and ensure safe and proper installation, use and maintenance.

Keep this manual in a convenient place so you can always refer to it for the safe and proper use of the appliance.

If you sell the appliance, give it away, or leave it behind when you move house, make sure you also pass this manual so that the new owner can become familiar with the appliance and safety warnings.

## Legend



Warning – Important Safety information



General information and tips



Environmental information

## Disposal



Help protect the environment and human health. Put the packaging in applicable containers to recycle it. Help to recycle waste of electrical and electronic appliances. Do not dispose appliances marked with this symbol with the household waste. Return the product to your local recycling facility or contact your municipal office.



## WARNING!

### **Risk of injury or suffocation!**

Disconnect the appliance from the mains supply. Cut off the mains cable and dispose of it. Remove the door catch to prevent children and pets to get closed in the appliance.

1-Safety information.....	4
2-Product description.....	7
3-Control panel.....	8
4-Programmes.....	12
5-Daily use.....	13
6-Eco-friendly washing.....	18
7-Care and cleaning.....	19
8-Troubleshooting.....	22
9-Installation.....	26
10-Technical data.....	30
11-E-waste Guideline Manual.....	31

# 1- Safety information

Before switching on the appliance for the first time read the following safety hints!



## WARNING!

### Before first use

- ▶ Make sure there is no transport damage.
- ▶ Make sure all transport bolts are removed.
- ▶ Remove all packaging and keep it out of children's reach.
- ▶ Handle the appliance always with at least two persons because it is heavy.

### Daily use

- ▶ This appliance can be used by children aged from 8 years and above and persons with reduced physical, sensory or mental capabilities, or lack of experience and knowledge if they have been given supervision or instruction concerning use of the appliance in a safe way and understand the hazards involved.
- ▶ Keep away children under 3 years of age from the appliance unless they are constantly supervised.
- ▶ Children shall not play with the appliance.
- ▶ Do not let children or pets come close to the appliance when the door is open.
- ▶ Store washing agents out of reach of children.
- ▶ Pull up zips, fix loose threads and take care of small item to prevent laundry from being entangled. If necessary, use an appropriate bag or net.
- ▶ Do not touch or use the appliance when barefoot or with wet or damp hands or feet.
- ▶ Do not cover or encase the appliance during operation or afterwards to allow any moisture or dampness to evaporate.
- ▶ Do not place heavy objects or sources of heat or damp on top of the appliance.
- ▶ Do not use or store **flammable** detergent or dry cleaning agent in close vicinity to the appliance.
- ▶ Do not use any **flammable** sprays in close vicinity to the appliance.
- ▶ Do not wash any garments treated with solvents in the appliance without having dried them previously in the air.

# 1-Safety information



## WARNING!

### Daily use

- ▶ Do not remove or insert the plug in the presence of flammable gas.
- ▶ Do not hot wash foam rubber or sponge-like materials.
- ▶ Do not wash any laundry which is polluted with flour.
- ▶ Do not open detergent drawer during any washing cycle.
- ▶ Do not press the door during the washing process, it gets hot.
- ▶ Do not open the door if the water level is visibly over the porthole.
- ▶ Do not force the door to open. The door is fitted with a self-lock device and will open shortly after the washing procedure is ended.
- ▶ Switch off the appliance after each washing programme and before undertaking any routine maintenance and disconnect the appliance from the electrical supply to save electricity and for safety.
- ▶ Hold the plug, not the cable, when unplugging the appliance.

### Maintenance / cleaning

- ▶ Make sure children are supervised if they carry out cleaning and maintenance.
- ▶ Disconnect the appliance from the electrical supply before undertaking any routine maintenance.
- ▶ Keep the lower part of the porthole clean and door and detergent drawer open if appliance is not in use, to prevent odours.
- ▶ Do not use water spray or steam to clean the appliance.
- ▶ Replace a damaged supply cord only by the manufacturer, its service agent or similarly qualified persons in order to avoid a hazard.
- ▶ Do not try to repair the appliance by yourself. In case of repair is needed please contact our customer service.

### Installation

- ▶ The appliance should be placed in a well-ventilated place. Ensure a location where allows to open the door fully.
- ▶ Never install the appliance outdoors in a damp place or in an area which may be prone to water leaks, such as under or near a sink unit. In the event of a water leak, cut off power supply and let the machine dry naturally.

# 1-Safety information



## WARNING!

### Installation

- ▶ Install or use the appliance only in where the temperature is above 5 °C.
- ▶ Do not place the appliance directly on a carpet or close to a wall or furniture.
- ▶ Do not install the appliance in direct sunlight or near heat sources (e.g. stoves, heaters).
- ▶ Make sure that the electrical information on the rating plate agrees with the power supply. If it does not, contact an electrician.
- ▶ Do not use multi-plug adapters and extension cables.
- ▶ Make sure only the delivered electric cable and hose set are used.
- ▶ Make sure the electric cable and plug are not damaged. If damaged, have it replaced by an electrician.
- ▶ Use a separate earthed socket for the power supply which is easily accessible after installation. The appliance must be earthed.
- ▶ Make sure the hose joints and connections are firm and without leakage.

### Intended use

This appliance is intended for washing machine-washable laundry only. Anytime the instructions given on the label of each garment label should be followed. It is designed exclusively for domestic use inside the house. It is not intended for commercial or industrial use. Changes or modifications to the device are not allowed. Unintended use may cause hazards and loss of all warranty and liability claims.

# 2-Product description

## **i** Note:

Due to technical changes and different models, the illustrations in the following chapters may differ from your model.

## 2.1 Picture of appliance (Picture is schematic, please refer to actual product)

Front (Fig. 2-1):

Rear side (Fig. 2-2):

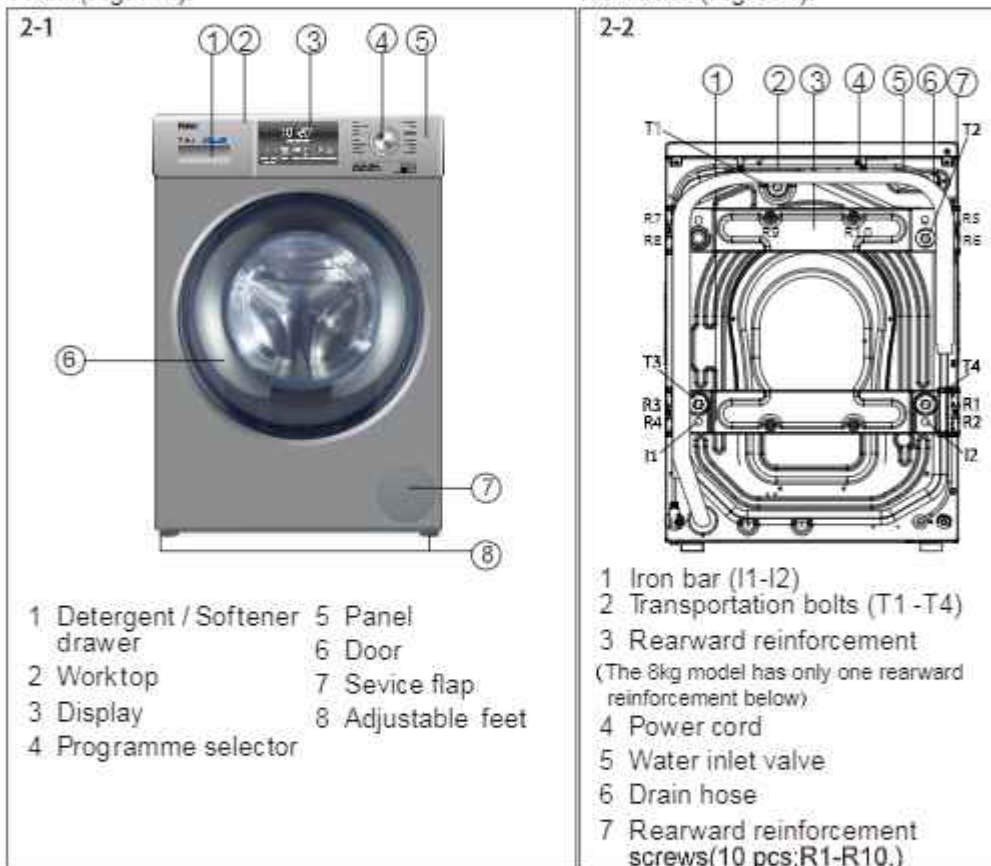

## 2.2 Accessories

Check the accessories and literature in accordance with this list (Fig.2-3):



# 3-Control panel

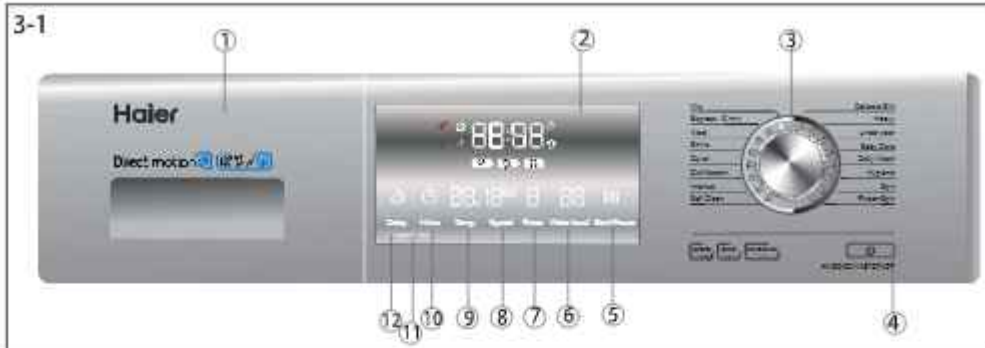

- 1 Detergent / Softener drawer
- 2 Display
- 3 Programme selector
- 4 "On/Off" button

Function buttons:

- 5 "Start/Pause" button
- 6 Water level
- 7 Rinse
- 8 Speed
- 9 Temp.
- 10 I-time
- 11 Child lock (Delay+I-time)
- 12 Delay

## Note : Acoustic signal

In following cases an acoustic signal sounds:



- ▶ when pressing a button
- ▶ when turning the programme selector
- ▶ at the end of programme
- ▶ in case of failures

The acoustic signal can be deselected if necessary; see DAILY USE.

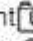

### 3.1 Detergent drawer

Open the drawer, three compartments can be seen (Fig. 3-2).

- ① Compartment : Disinfectant for programme
- ② Compartment : Liquid detergent for programme
- ③ Compartment : Softener, Conditioning agent etc.
- ④ Compartment : Powder detergent for programme



The recommendation on the type of detergents is suitable for the various washing temperatures, please refer to the manual of detergent.











### 3.2 Display

If the appliance is on, Display will light up the actual-status on different sections. The information including washing time, spin speed, temperature, etc will appear (Fig. 3-3).



# 3-Control panel

Display symbols:

Programme status indication		Programme cycle indication		
 Control panel is locked	 Door is locked (in operation)	 Remaining operation time	 Display for washing time, end time delay as well as error codes and service information.	
		 Remaining delay time		
 No water supply	 Door is open	 Wash cycle	 Rinse cycle	 Spin/drainage cycle

## 3.3 Programme selector

By turning the knob (Fig. 3-4) one of 16 programmes can be selected, related LED will light up, and its corresponding settings will be displayed.



## 3.4 "On/Off" button

Press this button (Fig. 3-5) to switch on, Press it again for about 2 seconds to switch off, if no panel element or programme is activated after a while machine will shut down automatically.



## 3.5 "Start/Pause" button

Press this button (Fig. 3-6) gently to start or interrupt the currently displayed programme. During programme run the colon in the displayed washing time is blinking. During a pause also the time display is blinking.



# 3-Control panel

3-7



## 3.6 Function buttons

The function buttons (Fig. 3-7) enable additional options in the selected programme before programme start. The related indicators are displayed.

By switching off the appliance or a programme running all options are disabled.

If a button has multiple options, the desired option can be selected by pressing the button sequentially.

To delete the setting or cancel the setting process, press the function button until the desired LED lights

or -in case of only one option- the LED switches off. Not all functions are available for all programmes (see PROGRAMMES).

### Note: Factory settings

To get best results in each programme we have well defined specific default settings. If there is no special requirement, default settings are recommended.

3-8

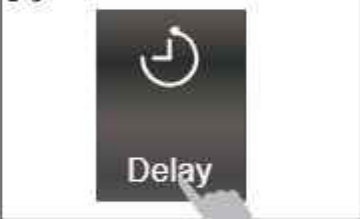

### 3.6.1 Function "Delay"

Press this button (Fig. 3-8) to start the programme with a delay. End time delay could be increased in a step of 30 minutes from 0.5-24h. For example, display off **6:30** means end of programme cycle will be in 6 hours and 30 minutes. Press "Start/Pause" button to activate the time delay.

The time delay must be longer than the programme run time. Otherwise the programme will start immediately.

For deactivating the time delay; rotate programme selector.

3-9



### 3.6.2 Function "I-time"

Press the "I-time" button (Fig. 3-9) to select or cancel "I-time" function, washing time can be increased or reduced by pressing the button sequentially.

(Not all functions are available for all programmes (see PROGRAMMES))

•

### Note: Liquid detergent

If using liquid detergent, it is not recommended to activate the end time delay.

# 3-Control panel

## 3.6.3 Function "Child lock"

This option blocks all panel elements against activation. After programme start press button "Delay" and "I-time" (Fig. 3-10) simultaneously for 3 seconds; child lock symbol is displayed. For unlocking, press again the two buttons.



## 3.6.4 Function "Temp."

Press this button (Fig. 3-11) to change the washing temperature of the programme. If no value is illuminated water will not be heated.



## 3.6.5 Function "Speed"

Press this button (Fig. 3-12) to change or deselect the spin of the programme. If no value is illuminated the laundry will not spin.



## 3.6.6 Function "Rinse"

Press this button (Fig. 3-13) to change or deselect rinse time. By pressing the button several times one to three cycles can be selected.



## 3.6.7 Function "Water level"

Press this button (Fig. 3-14) to change or deselect water level. By pressing the button several times L1 to L3 cycles can be selected.



# 4-Programmes

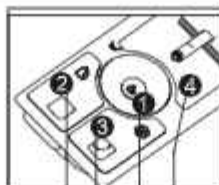

Detergent compartment for:

- ❶ Disinfectant
- ❷ Liquid detergent
- ❸ Softener, Conditioning agent etc.
- ❹ Powder detergent

• Yes, ◦ Optional, / No

Programme	Max. load in kg HW80-DM1 4876TNEP HW100-DM 14876TNEP	Temperature in °C		Recommended clothing type				Preset Spin speed in rpm	Function		
		max	Preset	☐	☐	☐	☐		Delay	I-time	
Mix	8/10	60	30	☐	☐	/	☐	Mixed-laundry of cotton and synthetic	1000	☐	☐
Express <sup>3)</sup> 15 min	0.8/1	40	* 1)	☐	☐	/	☐	Lightly soiled cotton and synthetic	1000	☐	☐
Wool	0.8/1	40	* 1)	☐	☐	/	☐	Machine-washable woollens fabric	800	☐	☐
Shirts	1.6/2	40	40	☐	☐	/	☐	Suitable for shirts	1000	☐	☐
Duvet	1.6/2	40	40	☐	☐	/	☐	Machine-washable duvet	800	☐	☐
Disinfectant	8/10	90 <sup>2)</sup>	30	☐	☐	•	☐	Disinfection for the clothes suitable	1000	☐	☐
Intense	8/10	90 <sup>2)</sup>	30	☐	☐	/	☐	Cotton	1000	☐	☐
Self Clean <sup>4)</sup>	/	90 <sup>2)</sup>	90 <sup>2)</sup>	/	/	/	/	/	600	/	/
Delicate/Silk	1.6/2	30	30	☐	☐	/	☐	Delicate laundry and silk	600	☐	/
Heavy	5.6/7	60	30	☐	☐	/	☐	Suitable for bedding	1000	☐	☐
Underwear	4/5	60	40	☐	☐	/	☐	Underwear	1000	☐	☐
Baby Care	4/5	90 <sup>2)</sup>	40	☐	☐	/	☐	Child laundry	1000	☐	☐
Daily Wash	4/5	60	30	☐	☐	/	☐	Casual wear	1000	☐	☐
Hygienic	4/5	90 <sup>2)</sup>	90 <sup>2)</sup>	☐	☐	/	☐	Cotton	1000	☐	☐
Spin	8/10	/	/	/	/	/	/	all fabrics	1000	/	/
Rinse+Spin	8/10	/	/	/	☐	/	/	all fabrics	1000	/	/

1) \*: Water is not heated up.

2) Choose 90 C wash temperature only for special hygienic requirements.

3) Reduce detergent amount because programme duration is short.

4) Do not use detergent instead of use a special machine cleaner.

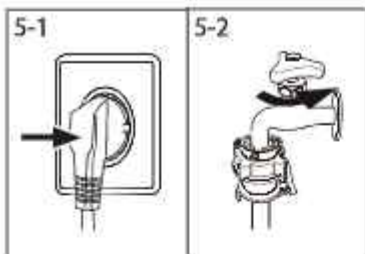

## 5.1 Power supply

Connect the washing machine to a power supply (220V /50Hz; Fig. 5-1). Please refer also to section **INSTALLATION**.

## 5.2 Water connection

- ▶ Before connecting check the cleanliness and clarity of the water inlet.
- ▶ Turn on the tap (Fig.5-2).

### **i** Note: Tightness

Before use check for leakage in the joints between the tap and the inlet hose by turning on the tap.



## 5.3 Preparing laundry

- ▶ Sort out clothes according to fabric (cotton, synthetics, wool or silk) and how dirty they are (Fig. 5-3). Pay attention to the care labelling of washing labels.
- ▶ Separate white clothes from coloured ones. Wash coloured textiles first by hand to check if they fade or run.
- ▶ Empty pockets (keys, coins, etc.) and remove harder decorative objects (e.g. brooches).
- ▶ Garments without hems, delicates and finely woven textile such as fine curtains are to be put into a wash bag to care for this delicate laundry (hand or dry cleaning would be better).
- ▶ Close zippers, velco fastener and hooks, make sure the buttons are sewn on tightly.
- ▶ Place sensitive items like laundry without firm hem, delicate underwear (Dessous) and small items such as socks, belts, bras, etc. in a wash bag.
- ▶ Unfold large pieces of fabrics such as bed sheets, bedspreads etc.
- ▶ pick out jeans and printed, decorated or color intensive textiles; possibly wash separately.

### **!** CAUTION!

Non-textile, as well as small, loose or sharp-edged items may cause malfunctions and damage of clothes and appliance.

# 5-Daily use

## Care chart

Washing		
 Washable up to 95°C normal process	 Washable up to 60°C normal process	 Washable up to 60°C mild process
 Washable up to 40°C normal process	 Washable up to 40°C mild process	 Washable up to 40°C very mild process
 Washable up to 30°C normal process	 Washable up to 30°C mild process	 Washable up to 30°C very mild process
 Wash by hand max. 40°C	 Do not wash	
Bleaching		
 Any bleaching allowed	 Only oxygen/non-chlorine	 Do not bleach
Drying		
 Tumble drying possible normal temperature	 Tumble drying possible lower temperature	 Do not tumble dry
 Line drying	 Flat drying	
Ironing		
 Iron at a maximum temperature up to 200 °C	 Iron at a medial temperature up to 150°C	 Iron at a low temperature up to 110 °C; without steam (steam ironing may cause irreversible damage)
 Do not iron		
Professional Textile Care		
 Dry cleaning in tetra-chloroethene	 Dry cleaning in hydrocarbons	 Do not dry clean
 Professional wet clean	 Do not professional wet clean	

## 5.4 Loading the appliance

- ▶ Put in the laundry piece by piece
- ▶ Don't overload. Note the different maximum load according to programmes! Rule of thumb for maximum load: Keep six inches between load and drum top.
- ▶ Close the door carefully. Make sure that no pieces of laundry are pinched.

## 5.5 Selecting detergent

- ▶ Washing efficiency and performance is determined by the using detergent quality.
- ▶ Use only machine wash approved detergent.
- ▶ If needed, use specific detergents, e.g. for synthetic and woolen fabric.
- ▶ Always follow detergent manufacturer's recommendations.
- ▶ Do not use dry cleaning agents such as trichloroethylene and similar products.

### Choose the best detergent

Programme	Kind of detergent				
	Universal	Colour	Delicate	Special	Softener
Mix	L/P	L/P	-	-	o
Express 15 min	-*	-	L	-	o
Wool	L	L	-	-	o
Shirts	L/P	L/P	L	-	o
Duvet	L/P	L/P	-	-	o
Disinfectant	L/P	L/P	-	L	o
Underwear	-*	-	-	L	o
Hygienic	L/P	L/P	-	-	o
Intense	L/P	L/P	-	-	o
<b>Heavy</b>	L/P	L/P	L	-	o
Baby Care	-	-	-	L	o
Delicate/Silk	L/P	L/P	L	*	o
Daily Wash	L/P	L/P	L	-	o

L = gel-/liquid detergent    P = powder detergent    O = optional    -- = no

If using liquid detergent, it is not recommended to activate the time delay.

We recommend by using:

- ▶ Laundry powder: 20°C to 90°C\* (best use: 40-60°C)
- ▶ Color detergent: 20°C to 60°C (best use: 30-60°C)
- ▶ Wool/delicate detergent: 20°C to 30°C (= best use:)

\* Choose 90 °C wash temperature only for special hygienic requirements.

\* It is better to use less or free suds detergent powder.

ⓘ In extremely low water pressure, it is requested to insert the detergent powder into the drum directly. Don't put detergent powder into the drawer, otherwise, it will be solidified in the drawer.

ⓘ It is better to use less or free suds detergent powder.

# 5-Daily use

## 5.6 Adding detergent

1. Slide out the detergent drawer.
2. Put the required chemicals into corresponding compartments (Fig. 5-4), refer to section 3.1 Detergent drawer.
3. Push back the drawer gently.



### **i** Note:

- ▶ Remove detergent residues before next wash cycle from the detergent drawer.
- ▶ Do not overuse detergent or softener.
- ▶ Please follow the instruction on the detergent package.
- ▶ Always fill the detergent just before the beginning of the wash cycle.
- ▶ Concentrated liquid detergent should be diluted before adding.
- ▶ Do not use liquid detergent if function "Delay" is selected.
- ▶ Carefully choose the programme settings according to the care symbols on all laundry labels and according to the programme table.

## 5.7 Switch on the appliance

Press the "Power" button for two seconds to switch on the appliance (Fig. 5-5).

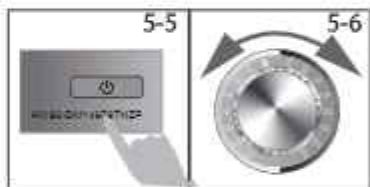

## 5.8 Select a programme

To get the best washing results, select a programme which fits the degree of soiling and sort of laundry type.

Turn the programme knob (Fig. 5-6) to select the right programme. Related programme LED lights up and the default settings are displayed.

### **i** Note: Self Clean

For regular maintenance we recommend to run programme Self Clean with no load in order to remove possible corruptive residues from time to time. Add a special machine cleaner.

## 5.9 Add individual selections

Select required options and settings (Fig. 5-7); refer to CONTROL PANEL.







## 5.10 Start wash programme

Press "Start/Pause" button (Fig. 5-8) to start; appliance operates according to present settings. Changes are only possible by cancelling the programme.

## 5.11 Interrupt - cancel wash programme

To interrupt a running programme press gently "Start/Pause". Programme run-time is flashing. Press it again to resume operation.

To cancel a running programme and all its individual settings:

1. Press "Start/Pause" button to interrupt the running programme.
2. Press "Power" button for about three seconds to switch the appliance off.
3. Run programme Spin to drain the water.
4. Select a new programme and start it.

### Note: Door lock

- ▶ For safety reasons the door is locked partially during the washing cycle. It is only possible to open the door at the end of the programme or after the programme was cancelled correctly (see description above); "door is open"-symbol is displayed.
- ▶ In case of high water level, high water temperature and during spinning it is not possible to open the door; the "door lock"-symbol is displayed.

## 5.12 After washing

1. At programme cycle end "End" is displayed.
2. The appliance switches off automatically.
3. Remove laundry as soon as possible to go easy on it and to prevent more wrinkling.
4. Turn off the water supply.
5. Unplug the power cord.
6. Open the door to prevent formation of moisture and odours. Let it open while not used.

### Note: Standby mode / energy-saving mode

The switched on appliance will go into standby mode if it will not be activated within two minutes before starting the programme or at the end of programme. The display switches off. This saves energy. To interrupt the standby-mode push "Power" button.

## 5.13 Activate or deactivate the buzzer

The acoustic signal can be deselected if necessary:

1. Switch on the appliance.
2. Select the Spin programme.
3. Press the "I-time" button and "Speed" button at the same time for about three seconds. "bBEEP OFF" will be displayed and the buzzer will be deactivated.

For activating the buzzer press these two buttons at the same time again. "bBEEP On" will be displayed.

## 6-Eco-friendly washing



### Environmentally responsible use

- ▶ To achieve best use of energy, water, detergent and time you should use the recommended maximum load size.
- ▶ Do not overload (hand width clearance above laundry).
- ▶ For slightly soiled laundry select the Quick Wash programme.
- ▶ Apply exact dosages of each washing agent.
- ▶ Choose the lowest adequate washing temperature - modern detergents are efficiently cleaning below 60°C.
- ▶ Raise default settings only due to heavy staining.
- ▶ Select max. spinning speed if a domestic dryer is used.

# 7-Care and cleaning

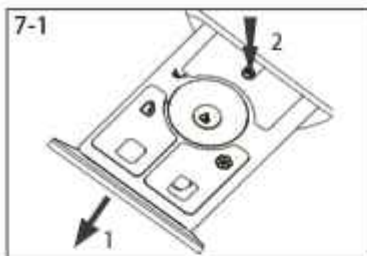

## 7.1 Cleaning the detergent drawer

Take always care there are no detergent residues. Clean the drawer regularly (Fig. 7-1):

1. Pull out the drawer until it stops.
2. Press the release button and remove the drawer.
3. Flush the drawer with water until it is clean and insert the drawer back in the appliance.



## 7.2 Cleaning the machine

- ▶ Unplug the machine during cleaning and maintenance.
- ▶ Use a soft cloth with soap liquid to clean the machine case (Fig. 7-2) and rubber components.
- ▶ Do not use organic chemicals or corrosive solvents.

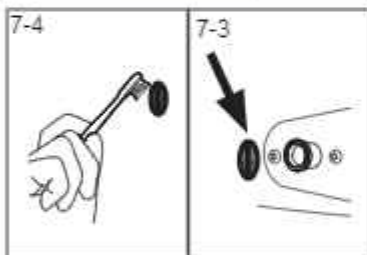

## 7.3 Water inlet valve and inlet valve filter

To prevent blockage of water supply by solid substances like lime clean regularly the inlet valve filter.

- ▶ Unplug the power cord and turn off the water supply.
- ▶ Unscrew the water inlet hose at the back (Fig. 7-3).
- ▶ Flush the filters with water and a brush (Fig. 7-4).
- ▶ Insert the filter and install the inlet hose.



## 7.4 Cleaning the drum

- ▶ Remove accidentally washed metal parts such as pins, coins, etc. from the drum (Fig. 7-5) because they cause rust stains and damage.
- ▶ Use a non-chloride cleaner for removing rust stains. Observe the warning hints of the cleaning agent manufacturer.
- ▶ Do not use any hard objects or steel wool for cleaning.



### Note: Self Clean

For regular maintenance we recommend to run programme Self Clean with no load in order to remove possible corruptive residues from time to time. Add a special machine cleaner. Each 50 working cycles, the Self Clean LED will blink in standby statue, after running Self Clean programme, the LED will turn off.

# 7-Care and cleaning

## 7.5 Long periods of disuse

If the appliance is left idle for a long period:

1. Pull out the electrical plug (Fig. 7-6).
2. Turn off water supply (Fig. 7-7).
3. Open the door to prevent formation of moisture and odours. Let door open while not used.

Before next usage check carefully power cord, water inlet and drain hose. Make sure everything is properly installed and without leakage.

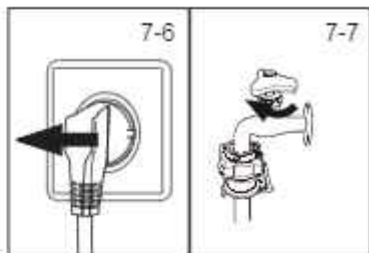

### **i** Note: Self Clean

After long periods of disuse we recommended to run programme Self Clean with no load and special machine cleaner to remove possibly corruptive residues.

## 7.6 Pump filter

Clean the filter once a month and check the pump filter for instance if the appliance:

- ▶ doesn't drain the water.
- ▶ doesn't spin.
- ▶ cause unusual noise while running.

### **!** WARNING!

Scalding Risk! Water in the pump filter can be very hot! Before any action please ensure water has cooled down.

1. Turn off and unplug the machine (Fig. 7-8).
2. Open service flap at the right corner of appliance front (Fig. 7-9).
3. Provide a flat container to catch leach water (Fig. 7-10). There could be a big amounts!
4. Pull the drain hose out and hold its end above the container (Fig. 7-10).
5. Take the sealing plug out of the drain hose (Fig. 7-10).
6. After complete drainage close drain hose and push it back into the machine (Fig. 7-11).
7. Unscrew and remove counter anticlockwise the pump filter (Fig. 7-12).
8. Remove contaminants and dirts (Fig. 7-13).

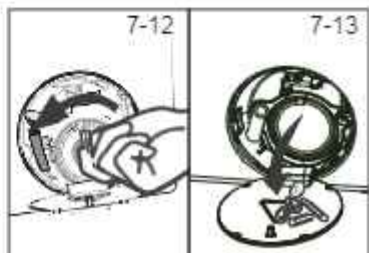
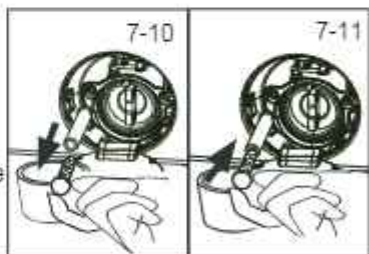
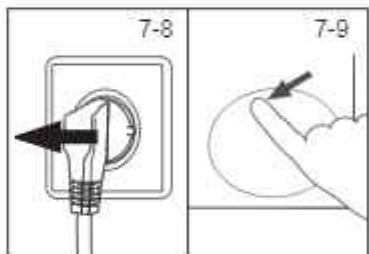

## 7-Care and cleaning

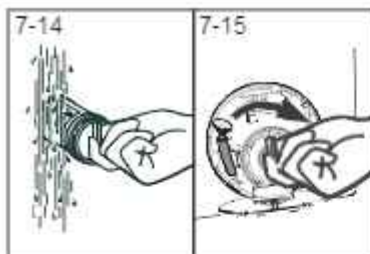

9. Carefully clean pump filter, e.g. using running water (Fig. 7-14).
10. Refix it thoroughly (Fig. 7-15).
11. Close service flap.



### CAUTION!

- ▶ Pump filter sealing has to be clean and unhurt. If the lid is not fully tightened, water can escape.
- ▶ The filter must be in place, or it may lead to leakage.

# 8-Troubleshooting

Many occurring problems could be solved by yourself without specific expertise. In case of a problem please check all shown possibilities and follow below instructions before you contact an after sales service. See CUSTOMER SERVICE.



## WARNING!

- ▶ Before maintenance, deactivate the appliance and disconnect the mains plug from the mains socket.
- ▶ Electrical equipment should be serviced only by qualified electrical experts, because improper repairs can cause considerable consequential damages.
- ▶ A damaged power cable should only be replaced by the manufacturer, its service agent or similarly qualified persons in order to avoid a hazard.

### 8.1 Information codes

Following codes are displayed only for information referring to the washing cycle. No measures must be performed.

Code	Message
00:25	The remaining wash cycle time will be 1 hour and 25 minutes.
6:30	The remaining wash cycle time including chosen end-time delay will be 6 hours and 30 minutes
Auto	Automatic load detection is working; only in some programs.
End	The washing cycle is finished. The appliance shuts off automatically.
Lock	Door is closed because of high water level, high water temperature or spinning cycle.
BEEP ON	The buzzer is activated.
BEEP OFF	The buzzer is deactivated.

# 8-Troubleshooting

## 8.2 Troubleshooting with display code

Problem	Cause	Solution
E1	<ul style="list-style-type: none"><li>• Drainage error, water is not fully drained</li></ul>	<ul style="list-style-type: none"><li>• Clean pump filter.</li><li>• Check drain hose installation.</li></ul>
E2	<ul style="list-style-type: none"><li>• Lock - error.</li></ul>	<ul style="list-style-type: none"><li>• Shut the door properly.</li></ul>
F3	<ul style="list-style-type: none"><li>• Temperature sensor - error.</li></ul>	<ul style="list-style-type: none"><li>• Contact the After sales service.</li></ul>
E4	<ul style="list-style-type: none"><li>• Water level not reached after 30 minutes at the lasted.</li><li>• Drain hose is self-syphoning.</li></ul>	<ul style="list-style-type: none"><li>• Make sure that tap is fully opened and water pressure is normal.</li><li>• Check drain hose installation.</li></ul>
F4	<ul style="list-style-type: none"><li>• Heating error.</li></ul>	<ul style="list-style-type: none"><li>• Contact the After sales service.</li></ul>
F7	<ul style="list-style-type: none"><li>• Motor - error.</li></ul>	<ul style="list-style-type: none"><li>• Contact the After sales service.</li></ul>
E8	<ul style="list-style-type: none"><li>• Water protective level - error.</li></ul>	<ul style="list-style-type: none"><li>• Contact the After sales service.</li></ul>
FA	<ul style="list-style-type: none"><li>• Water level sensor error.</li></ul>	<ul style="list-style-type: none"><li>• Contact the After sales service.</li></ul>
FC0 FC1 or FC2	<ul style="list-style-type: none"><li>• Abnormal communication error.</li></ul>	<ul style="list-style-type: none"><li>• Contact the After sales service.</li></ul>
unb	<ul style="list-style-type: none"><li>• Unbalanced load - error.</li></ul>	<ul style="list-style-type: none"><li>• Check and balance laundry load in the drum. Reduce the load.</li></ul>

# 8-Troubleshooting

## 8.3 Troubleshooting without display code

Problem	Cause	Solution
Washing machine fails to operate.	<ul style="list-style-type: none"><li>• Programme is not yet started.</li><li>• Door is not properly closed.</li><li>• Machine has not been switched on.</li><li>• Power failure.</li><li>• Child lock is activated.</li></ul>	<ul style="list-style-type: none"><li>• Check programme and start it.</li><li>• Close the door properly.</li><li>• Switch the machine on.</li><li>• Check power supply.</li><li>• Deactivate child lock.</li></ul>
Washing machine will not be filled with water.	<ul style="list-style-type: none"><li>• No water.</li><li>• Inlet hose is kinked.</li><li>• Inlet hose filter is blocked.</li><li>• Water pressure is less than 0.03 MPa.</li><li>• Door is not properly closed.</li><li>• Water supply failure.</li></ul>	<ul style="list-style-type: none"><li>• Check water tap.</li><li>• Check inlet hose.</li><li>• Unblock inlet hose filter.</li><li>• Check water pressure.</li><li>• Close the door properly.</li><li>• Ensure the water supply.</li></ul>
Machine is draining while being filled.	<ul style="list-style-type: none"><li>• Height of drain hose is below 80 cm.</li><li>• Drain hose end could reach into water.</li></ul>	<ul style="list-style-type: none"><li>• Make sure that drain hose is properly installed.</li><li>• Make sure the drain hose is not in water.</li></ul>
Drainage failure.	<ul style="list-style-type: none"><li>• Drain hose is blocked.</li><li>• Pump filter is blocked.</li><li>• Drain hose end is higher than 100 cm above floor level.</li></ul>	<ul style="list-style-type: none"><li>• Unblock drain hose.</li><li>• Clean pump filter.</li><li>• Make sure that drain hose is properly installed.</li></ul>
Strong vibration while spinning.	<ul style="list-style-type: none"><li>• Not all transportation bolts have been removed.</li><li>• Appliance has no solid position.</li><li>• Machine load is not correct.</li></ul>	<ul style="list-style-type: none"><li>• Remove all transportation bolts.</li><li>• Ensure solid ground and a levelled position.</li><li>• Check load weight and balance.</li></ul>
Operation stops before completing wash cycle.	<ul style="list-style-type: none"><li>• Water or electric failure.</li></ul>	<ul style="list-style-type: none"><li>• Check power and water supply.</li></ul>
Operation stops for a period of time.	<ul style="list-style-type: none"><li>• Appliance displays error code.</li><li>• Problem due to load pattern.</li><li>• Programme performs soaking cycle</li></ul>	<ul style="list-style-type: none"><li>• Consider display codes.</li><li>• Reduce or adjust load.</li><li>• Cancel programme and restart.</li></ul>
Excessive foam floats drum and/or detergent drawer.	<ul style="list-style-type: none"><li>• Detergent is not appropriate.</li><li>• Excessive use of detergent.</li></ul>	<ul style="list-style-type: none"><li>• Check detergent recommendations.</li><li>• Reduce amount of detergent.</li></ul>
Automatic adjustment of washing time.	<ul style="list-style-type: none"><li>• Washing programme duration will be adjusted.</li></ul>	<ul style="list-style-type: none"><li>• This is normal and doesn't affect functionality.</li></ul>
Spinning fails.	<ul style="list-style-type: none"><li>• Unbalance of laundry.</li></ul>	<ul style="list-style-type: none"><li>• Check machine load and laundry and run a spinning programme again.</li></ul>



# 8-Troubleshooting

Problem	Cause	Solution
Unsatisfactory washing result.	<ul style="list-style-type: none"><li>• Degree of pollution does not agree with selected programme.</li><li>• Detergent quantity was not sufficient.</li><li>• Maximum load has been exceeded.</li><li>• Laundry was unevenly distributed in the drum.</li></ul>	<ul style="list-style-type: none"><li>• Select another programme.</li><li>• Choose the detergent acc. to the degree of pollution and acc. to manufacturer specifications.</li><li>• Reduce loading.</li><li>• Loose the laundry.</li></ul>
Washing powder residues are on the laundry.	<ul style="list-style-type: none"><li>• Insoluble particles of detergent can remain as white spots on the laundry.</li></ul>	<ul style="list-style-type: none"><li>• Perform extra rinse.</li><li>• Try to brush the points from the dry laundry.</li><li>• Choose an other detergent.</li></ul>
Laundry has grey patches.	<ul style="list-style-type: none"><li>• Caused by fats such as oils, creams or ointments</li></ul>	<ul style="list-style-type: none"><li>• Pretreat the laundry with a special cleaner.</li></ul>

If error codes are still displayed after these measures, switch off the appliance, disconnect the power supply and contact the customer service.

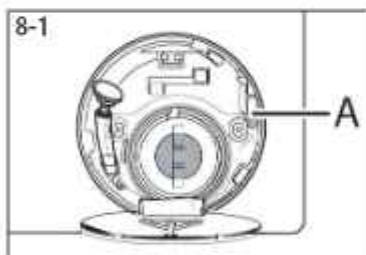

## 8.4 In case of power outage

The current programme and its setting will be saved. When power supply is restored, previous operation will be resumed.

If a power failure cuts an operating wash programme, door opening is mechanically blocked. To get out any laundry water level should not be seen in the glassy porthole of the door. Not till then pull lever (A) beneath service flap (Fig. 8-1) until door is unlocked by a gentle click. Afterwards refix all parts

# 9-Installation

## 9.1 Preparation

- ▶ Take the appliance out of the packaging.
- ▶ Remove all packaging material including protecting film on cabinet, polystyrene base, keep them out of children's reach. While opening the package, water drops may be seen on plastic bag and porthole. This normal phenomenon results from water tests in the factory.



### Note: Packaging disposal

Keep all packaging materials out of children's reach and dispose them in an environmentally friendly manner.

## 9.2 Bottom plate installation

When opening the package, you will find a bottom plate. It is used for preventing rats or foreign objects into the washing machine after covering the bottom of the cabinet.

1. Prepare Bottom plate 1EA and bolts 2EA (Fig. 9-1).
2. Lay the washing machine down to its side, window upwards, bottom side towards operator (Fig. 9-2).
3. Insert the Bottom plate into the cabinet. Then fixed with 2 screws to the cabinet on the window side (Fig. 9-3). Finally set the machine upright again.

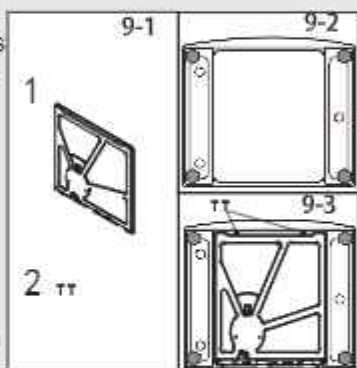

## 9.3 Dismantle the transport protection

The transport protection on the rear side is designed for clamping anti-vibration components inside the appliance during transportation to prevent inner damage. All elements (I, R, S and T, fig. 9-4) must be removed before use:

1. Remove all 4 bolts (T1-T4) (Fig. 9-5).

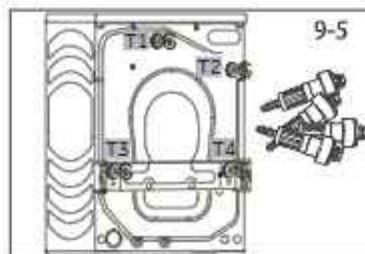
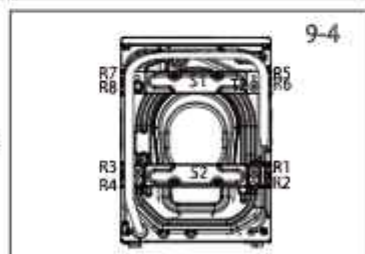

# 9-Installation

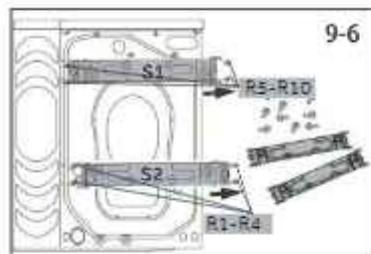

2. Remove 10 screws (R1-R10) from back reinforcement (Fig. 9-6) and put aside, and the 8kg model has only one rearward reinforcement below.

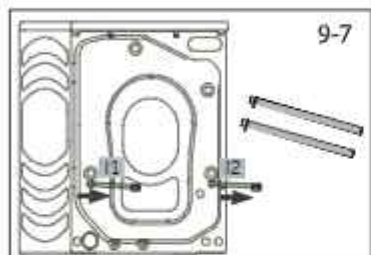

3. Pull out the 2 iron bars I1 and I2 (Fig. 9-7).

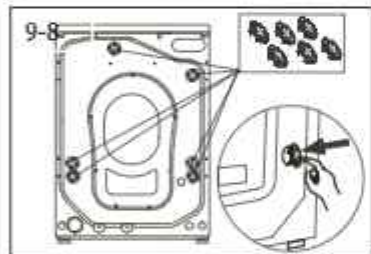

4. Fill the 6 left holes with blanking plugs (Fig. 9-8)

## **i** Note: Keep in safe place

Keep all parts of the transport protection in a safe place for later use. Whenever the appliance is to be moved at first reinstall the protection parts.

### 9.4 Moving the appliance

If the machine is to be moved to a distant location, replace the transport protection before installation to prevent damage. The assembly takes place in reverse order.

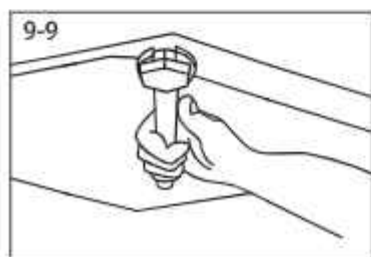

### 9.5 Adjusting the feet

Install the appliance on solid ground. Adjust all feet (Fig. 9-9) to achieve a complete level position. This will minimize vibrations and thus noise during use. It will also reduce wear and tear. We recommend to use a spirit level for adjustment. Floor should be as stable and flat as possible.

# 9-Installation

## 9.6 Drain Water Connection

Fix the water drain hose properly to the piping. The hose has to reach at one point a height between 80 and 100 cm above the appliance bottom line! If possible keep always drain hose fixed to the clip at the appliance back.



### WARNING!

- ▶ Use only the supplied hose set for the connection.
- ▶ Never reuse old hose sets!
- ▶ Only connect to cold water supply.
- ▶ Before connection, check whether the water is clean and clear.

Following connections are possible:

#### 9.6.1 Drain hose to sink

- ▶ Hang the drain hose with the U-support over the edge of a sink with adequate size (Fig. 9-10).
- ▶ Protect the U-support sufficiently against slipping.

#### 9.6.2 Drain hose to waste water connection

- ▶ The internal diameter of the stand pipe with vent-hole must be minimum 40 mm.
- ▶ Put the drain hose for approx. 80 mm in the wastewater pipe.
- ▶ Attach the U-support and secure it sufficiently (Fig. 9-11).

#### 9.6.3 Drain hose to sink connection

- ▶ The junction must lie above the siphon
- ▶ A spigot connection is usually closed by a pad(A) That must be removed to prevent any dysfunction (Fig. 9-12).
- ▶ Secure the drain hose with a clamp.

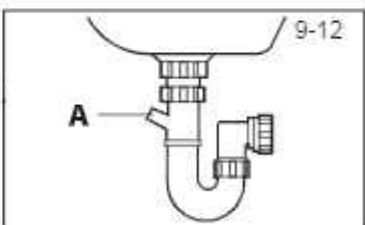
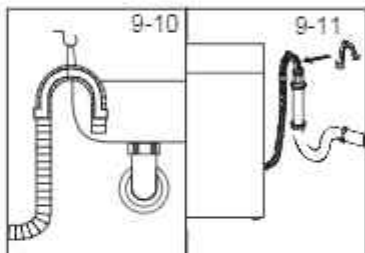

### CAUTION!

- ▶ The drain hose should not be submerged in water and should be securely fixed and leak-free. If the drain hose is placed on the ground or if the pipe is at a height of less than 80cm, the washing machine will continuously drain while being filled (self siphoning).
- ▶ Drain hose is not to be extended. If necessary contact after sales service.

# 9-Installation

## 9.7 Fresh Water Connection

Connect the nut on the inlet hose to the connector on the water valve (Fig. 9-13 ).

a. Hold down the lower end of the lock pole, Then hold the inlet pipe, press on the slider, and remove the water inlet joint (Fig. 9-14).

b. Loosen the four screws of the water inlet joint and fit the water inlet joint on the faucet, Make sure the screws is in place and tighten it (Fig. 9-15).

c. Press the slider and insert the water pipe into the water inlet joint, hang the water inlet joint with a lock pole and release the slider until a "snap" is heard (picture Fig. 9-16 and 9-17 ).

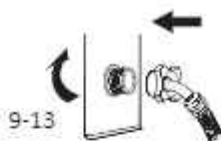

9-13

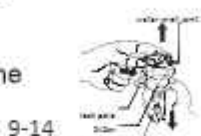

9-14



9-15  
screw



9-16



9-17

-  Use the hose-set supplied with the appliance.  
Old hose-sets should not be reused.

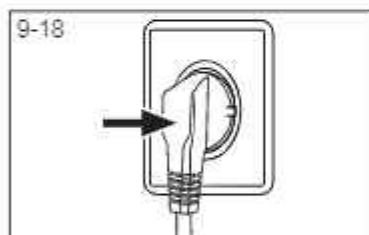

9-18

## 9.8 Electrical Connection

Before each connection check if:

- ▶ power supply, socket and fusing are appropriate to the rating plate.
- ▶ the power plug and socket are strictly according. Put the plug into the socket(Fig. 9-18).



### WARNING!

- ▶ Ensure always that all connections(power supply, drain and fresh water hose) are firm, dry and leak free!
- ▶ Take care these parts are never to be crushed, kinked, or twisted.
- ▶ If the supply cord is damaged, it must be replaced by the service agent (see warranty card) in order to avoid a hazard.



### Note: Self Clean

After each installation or long periods of disuse, before first use and for regular maintenance run programme Self Clean with no load and special machine cleaner to remove possibly corruptive residues.

# 10-Technical data

## 10.1 Technical data

Model	HW80-DM14876TNZP	HW100-DM14876TNZP
Dimension (HxWxD in mm)	850x595x460	850x595x530
Power supply	220 -240 V/50Hz	220-240 V/50Hz
Current in A	10	10
Max power in W	1900	1900
Water pressure in MPa	$0.03 \leq P \leq 1$	$0.03 \leq P \leq 1$
Net weight in kg	72	77

# E-waste Guideline Manual



## Introduction

We at Haier in our continuous efforts of making a future better adopted eco-friendly practices and procedures. We acting towards our social, moral and statutory responsibility towards the environment and sustainable development have pledged to recycle electronic items, such as TV/LED/LCD, refrigerator, washing machine, etc. that are no longer useful. Haier is stepping towards leading a more conservation and optimization of resources and thereby making environment safer. We request you to donate or utilize take back scheme for your electronic good when it reaches its end-of-life, so that it can be reuse -recycle and reinvent.

**Hazard of e-waste on environment and Human Health :-**

The informal method of recycling extends health hazards. Primary and secondary exposure to toxic metals, such as lead, results in diseases like Heart, Liver, Lung & Spleen Damage. Open-air burning of electronic waste, used

to retrieve valuable components such as gold, not only causes damages to environment but also to human health. Incineration from burning e-waste creates fine particulate matter, which is linked to heart and respiratory disease. However the above said is only example and the informal way to recycle causes numerous health hazards. During such informal recycling no caution or care are kept to either secure the environment or human health. The informal method of recycling extended environment hazards too. For example when different e-waste is burnt to extract metals from it, toxic chemicals are released in to the air, damaging the atmosphere. Such informal ways creates noise, water and air pollution.

**E-WASTE TOXIC COMPONENT & THEIR DAMAGE TO HUMAN HEALTH**

Toxic Materials	Birth Defects	Brain Damage	Heart, Liver, Lung & Spleen Damage	Kidney Damage	Nervous/ Reproductive System Damage	Skeletal System Damage
Barium	✓	✗	✗	✓	✓	✓
Cadmium	✗	✓	✗	✗	✗	✗
Lead	✗	✗	✓	✗	✗	✓
Lithium	✗	✗	✗	✗	✗	✓
Mercury	✗	✗	✗	✗	✓	✓
Nickel	✗	✓	✗	✗	✗	✓
Palladium	✗	✗	✗	✗	✓	✓
Rhodium	✓	✓	✗	✓	✓	✓
Silver	✗	✗	✗	✗	✗	✓

Without safe recycling, most of these toxic components will end in land fill-poisoning soil and water

# 11-E-waste Guideline Manual

**Why proper handling and management of e-waste :**

The electrical and electronic equipment (EEE) have valuable materials and hazardous/toxic substances in their components. The electronic products and electrical equipment after their useful life may not cause any harm if it is stored safely in households/stores. However, if the E-waste is opened-up and attempts are made for retrieval of useful components or material in an **un-scientific** manner or if the material is disposed in open, then it may cause health risks and damage to environment. E-waste can be considered as a resource that contains useful material of economic benefit for recovery of plastics, iron, glass, aluminum, copper and precious metals such as silver, gold, platinum, and palladium and lead, cadmium, mercury etc. However, at the same time presence of heavy metals (As, Cd, Hg, Pb etc.) and other toxic substances such as polychlorinated biphenyls (PCBs), etched chemicals, etc. may pose risk to health and environment during handling and recovery operations. E-waste is a problem of increasing proportions especially when crude methods are adopted for recovery of useful components from E-waste.

Thus, there is a need to encourage **OUR SELF** for recycling of all useful and valuable material from e-waste so as to conserve the ever depleting natural resources. Electronic component are increasingly made from recycled materials, for example for making new LCDs, more than 50% of indium is sourced by recycling used LCDs. The E-waste thus presents a scenario of urban mining for recovery of ferrous/non-ferrous/ rare earth metal and precious metal in addition to plastics and glass. However, presence of hazardous and toxic substances in the component of e-waste necessitates environmentally sound management of e-waste including collection and recycling/treatment in an environmentally sound manner.

**Management and Effect on sustainable future:-**

Sustainable development as defined by Brundtland Commission is "development that meets the needs of the present without compromising the ability of future generations to meet their own needs."

The e-waste since a long time had been seen as an easy and cheapest source of metals. However due to lack of proper consideration for such source of metals as well as proper methods of recycling in India, we sent our e-waste to the improper channel/scrap vendor and thereby participated in degrading the environment. Moreover, through this improper method of extraction of metals we till date had wasted approximately 40% of the precious metals and simultaneously caused damage to our environment. If we opt the proper way to extract metals through proper channel of recycling then we can achieve approximately 90% of extraction rate of our metals as well as a better way to save our environment. However, if today while selling off our material to improper channel we will not think about our sustainable future then it is for sure that the coming generations will be facing crisis of the metals.

**Customer responsibility**

- consumers shall ensure that their end of life product/e-waste is channelized through collection center or dealer of authorized producer or dismantler or recycler or through the designated take back service/provider of the producer to authorized dismantler or recycler;
- consumers shall ensure that such end-of-life electrical and electronic equipment are not admixed with e-waste containing radioactive material;

**Electronic Waste Recycling:**

**Do's**

- Handover/Donate/Give the discarded Electronic Equipment's only at the authorized collection centers.
- Drop the discarded Electronic Equipment's only in the bins meant for the Electronic Waste.
- Ask the retailer about the Take Back schemes.
- Consult the authorized service center as to whether the Electronic Equipment can be repaired or not, before discarding the same.
- Tell your neighbors and other persons about the hazards of improper disposal or handling or improper recycling of the Electronic Waste.
- If the unwanted Electronic Equipment still work or can be repaired then consider donating them.
- To minimize our impact on the earth and to protect the environment for future generations return your discarded Electronic Equipment's here for safe recycling :

**Don'ts**

- Don't dump the discarded Electronic Equipment's in open or in any Land Fill Site as the same will result in contaminating the Soil and the ground water.
- Don't dispose of the discarded Electronic Equipment's in household bins or Municipal Bins.
- Don't sell or give your discarded Electronic Equipment's to any Trash Dealer or Kabadiwala/unauthorized vendor.
- Don't try to open up the product by yourself for repair or other purposes.
- Don't mix the electronic waste into household waste stream.
- Don't keep any replaced spare part(s) from the product in exposed area. Always handover such article to service personal so that same can be recycled.

Haier Appliances (India) Pvt. Ltd.

Building No. 1, Okhla Industrial Estate,

Phase III, New Delhi - 110020

or Call us at

Toll Free No. (24X7) : 1800-419-9999, 1800-102-9999











**Haier**

0020506943LA